

# WIRELESS WI-FI DATA LOGGER

## Measures Temperature/Humidity, Integral LCD

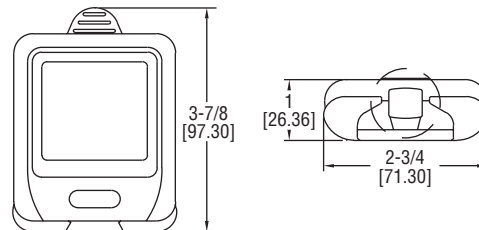

The **SERIES DW-WIFI** Wireless Wi-Fi Data Logger measures and records up to 1,000,000 temperature and/or humidity readings and shares the data with any PC or server on the same Wi-Fi network. If the Wi-Fi connection is lost, the sensor will continue to store any records until it can regain communication with the network. The downloadable Windows® based software allows users to set high/low alarms, sampling rate, and the temperature scale.

### FEATURES/BENEFITS

- Continues to record values even if Wi-Fi connection is lost
- Able to record up to 1,000,000 data points, which can be downloaded to a PC
- Large LCD allows users to view data directly from unit

### APPLICATIONS

- Building/site monitoring
- Environment monitoring
- Weather monitoring

### SPECIFICATIONS

**Memory Size:** 1,000,000 readings; 500,000 each for DW-WIFI-TH(-HA).  
**Sampling Mode:** Continuous recording.  
**Sampling Rate:** Selectable from 10 s to 12 hr.  
**Transmission Rate:** Selectable from 1 min to 24 hr.  
**Temperature Limits:** -4 to 140°F (-20 to 60°C).  
**Power Requirements:** 3.7 V lithium ion battery, installed functional, factory replaceable (cable for charging included).  
**Alarms:** Programmable high/low.  
**Interface:** Wi-Fi connection.  
**Probe Length:** DW-WIFI-TP: 11.8" (30 cm); DW-WIFI-TC: 59" (150 cm).  
**Weight:** 7.2 oz (204 g).  
**Agency Approvals:** CE.

### MODEL CHART

Model	Input	Range	Accuracy (Typ.)	Display Resolution
DW-WIFI-T	Internal temperature	-4 to 140°F (-20 to 60°C)	±1.0°F (±0.5°C) @ 14 to 122°F (-10 to 50°C)	0.1°F (0.1°C)
DW-WIFI-TH	Internal temperature/humidity	-4 to 140°F (-20 to 60°C), 0 to 100% RH	±0.6°F (±0.3°C) @ 41 to 140°F (5 to 60°C) ±2.5% RH @ 20 to 80% RH	0.5°F (0.5°C) 1.0% RH
DW-WIFI-TP	Remote temperature probe	-40 to 257°F (-40 to 125°C)	±1.2°F (±0.6°C) @ 14 to 158°F (-10 to 70°C)	0.1°F (0.1°C)
DW-WIFI-TC	Remote thermocouple	-454 to 2372°F (-270 to 1300°C)*	±3.0°F (1.5°C)	0.1°F (0.1°C)
DW-WIFI-T-HA	Internal temperature	-4 to 140°F (-20 to 60°C)	±0.2°F (±0.1°C) @ 14 to 140°F (-10 to 60°C)	0.1°F (0.01°C)
DW-WIFI-TH-HA	Internal temperature/humidity	-4 to 140°F (-20 to 60°C), 0 to 100% RH	±0.4°F (±0.2°C) @ 41 to 140°F (5 to 60°C) ±2.5% RH @ 10 to 90% RH	0.5°F (0.5°C) 1.0% RH
DW-WIFI-TP-HA	Remote temperature probe	-40 to 257°F (-40 to 125°C)	±0.2°F (±0.1°C) @ 14 to 158°F (-10 to 70°C)	0.01°F (0.01°C)

\*Probe dependent