

How to Install the Cata-DyneTM Protection Grill

The protection grill provided by CCI Thermal as an optional accessory for the Cata-DyneTM heater has been redesigned to allow for easy installation and/or removal. The 12" x 24" grill(s) are fastened to the bezel assembly. The bezel assembly is the rectangular steel frame riveted around the front of the Cata-DyneTM heater. No assembly hardware or tools are required to attach the grill(s).

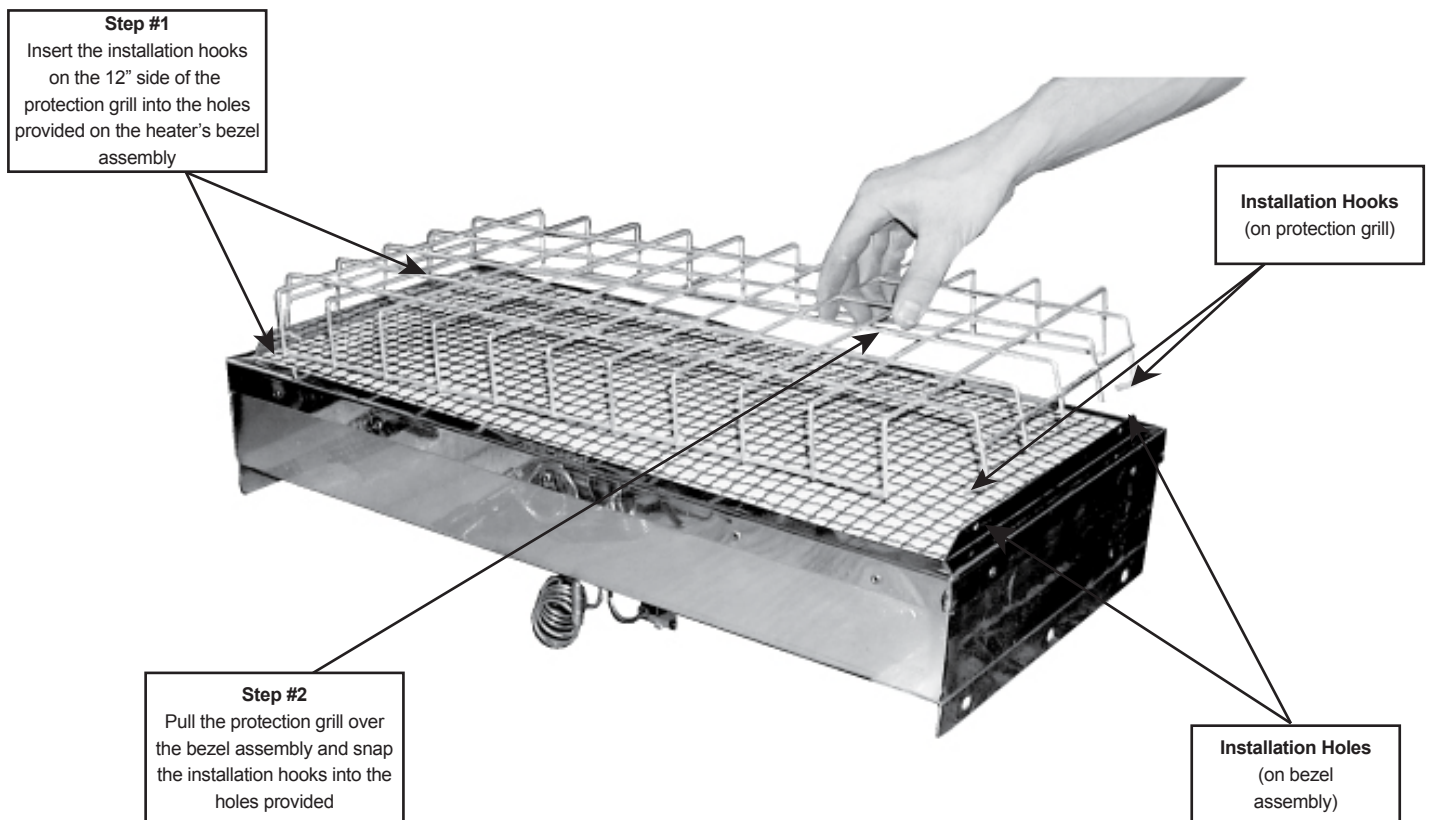

- To remove the protection grill, perform the above steps in reverse order.
- Exercise care not to damage the heater's catalyst pad when installing or removing the protection grill.

Caution! Do not Attempt to Install or Remove the Protection Grill While the Heater is in Operation.