



Check valve for water and air

- Brass or Stainless steel body
- Internal parts stainless steel

Non-return valve for horizontal or vertical installation.

Technical data - Type TFU002, heavy design	
Orifice	DN 10 to 40 mm
Body material	pressed brass CW 617N
Valve cone	Polyamide (PA)
Spring	Stainless steel
Sealing	NBR
Nominal pressure	see ordering chart
Opening pressure*	0.02 bar
Medium temperature	-20 °C to max. +100 °C
Installation	horizontal or vertical

Technical data - Type TFU002, light Design	
Orifice	DN 10 to 100 mm
Body material	pressed brass CW 617N
Valve cone	Polyamide (PA)
Spring	Stainless steel
Sealing	NBR
Nominal pressure	see ordering chart
Opening pressure*	0.02 bar
Medium temperature	max. 100 °C
Installation	horizontal or vertical

Technical data - Type TFU002, angle seat form	
Orifice	DN 8 to DN 50
Body material	Stainless steel 1.4408
Sealing	PTFE
Nominal pressure	see ordering chart
Opening pressure*	0.8 bar
Medium temperature	-20 °C to +200 °C
Installation	horizontal or vertical

* Pressure values [bar]: Overpressure with respect to atmospheric pressure

Other versions on request

Ordering chart check valve for water

Brass body, heavy Design

DN [mm]	Port connection ISO 228/1	H [mm]	L [mm]	Nominal pressure [bar] ¹⁾	Flow rate KV	Item no.
10	G 3/8	47,0	27,0	40	3,7	783 275
15	G 1/2	59,0	34,5	40	5,8	783 276
20	G 3/4	65,0	42,0	40	8,6	783 277
25	G 1	75,0	49,0	25	13,8	783 278
32	G 1 1/4	83,0	61,0	25	20,2	783 279
40	G 1 1/2	89,0	73,0	16	30,9	783 280
50	G 2	101,5	88,0	16	48,8	783 281

Brass body, light Design

DN [mm]	Port connection ISO 228/1	H [mm]	L [mm]	Nominal pressure [bar] ¹⁾	Flow rate KV	Item no.
10	G 3/8	45,0	34,0	16	2,8	783 285
15	G 1/2	45,0	28,0	40	3,7	783 286
20	G 3/4	48,0	35,0	40	5,8	783 287
25	G 1	56,0	42,0	25	8,6	783 288
32	G 1 1/4	62,0	51,0	25	13,8	783 289
40	G 1 1/2	69,0	61,0	16	20,2	783 290
50	G 2	77,0	73,0	16	30,9	783 291
65	G 2 1/2	93,0	90,0	12	48,8	783 292
80	G 3	113,0	113,0	12	79,4	783 293
100	G 4	135,0	140,0	10	124,9	783 294

* Pressure values [bar]: Overpressure with respect to atmospheric pressure

Stainless steel body, angle seat form

DN [mm]	Port connection DIN 2999	H [mm]	L [mm]	Nominal pressure [bar] ¹⁾	Flow rate KV	Item no.
8	1/4 R	30,0	65,0	40	3,7	783 305
10	3/8 R	30,0	65,0	40	3,7	783 306
15	1/2 R	34,0	65,0	40	5,8	783 307
20	3/4 R	39,0	75,0	40	8,6	783 308
25	1 R	42,0	90,0	40	13,8	783 309
32	1 1/4 R	50,0	110,0	40	20,2	783 310
40	1 1/2 R	57,0	120,0	40	30,9	783 311
50	2 R	70,0	150,0	40	48,8	783 312

* Pressure values [bar]: Overpressure with respect to atmospheric pressure

Dimensions [mm]

Brass body, heavy Design

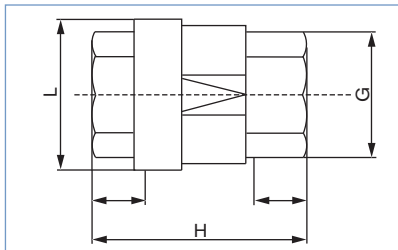

Brass body, light Design

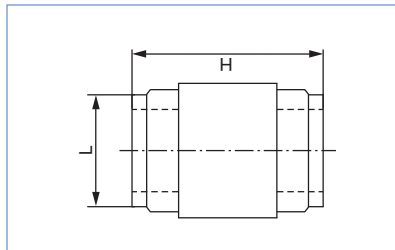

Stainless steel body, angle seat form

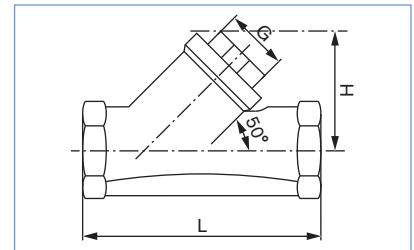

To find your nearest Bürkert facility, click on the orange box →

www.burkert.com

In case of special application conditions, please consult for advice.

We reserve the right to make technical changes without notice.
© Christian Bürkert GmbH & Co. KG

1512/1_EU-en_00895233